

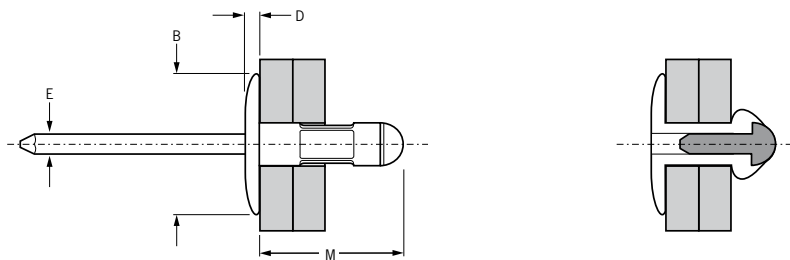

English	Français	Deutsch	Italiano	Español
Large Flange	Tête large	Flachrundkopf extragroß	Testa larga	Cabeza ancha
Body: Aluminium alloy* (2.5 % Mg) Natural	Corps: Alliage d'aluminium* (2.5% Mg) Brut	Hülse: Aluminium* (2.5 % Mg) Blank	Corpo: Lega di alluminio* (2.5% Mg) Nessuna finitura	Cuerpo: Aluminio* (2.5% Mg) Natural
Stem: Stainless steel** Natural	Tige: Inox** Brut	Dorn: Edelstahl** Blank	Gambo: Acciaio inox** Nessuna finitura	Vástago: Acero inoxidable** Natural

\*: AA 5052, DIN 1725, AlMg2.5, Werkstoff 3.3523

\*\* : BS3111, 321S31, AISI 321, Werkstoff 1.4541



ø					M	B	D	E			Part No/ref			
	nom.	min.	max.	min.								max.	max.	max.
3/16" (4.8 mm)	.062	.250	.193	.199	.534	.637	.084	.112				01643-00613		
	.250	.500			.774							270	450	01643-00621
	.500	.781			1.086							292	01643-00631	

all dimensions in inches / en pouces / alle Maße in Zoll / in pollici / en pulgadas

1) typical values / valeurs moyennes / typische Werte / Valori tipici / resistencias máximas recomendadas